

**1. PLUG : Type SAA/3+1309**

Molded plug according to	: AS/NZS 3112
Rated current and voltage	: 10A, 250 V AC
Plug base	: PPO GFR
Pins	: solid brass, nickel plated, crimped
Pins outer diameter	: 6,35 mm x 1,63 mm, line and neutral part insulated
Mechanical fixation	: iron wire ZN plated D1,00
Outer mold	: PVC compound, hardness Shore A75-77
Approvals	: SAA

2. CORD : Type H05RRF3G1,00mm²**BLACK**

Flexible cord according to	: EN 50525-2-21, EN 50575, OVE K40
Marked	: *manufacturer*testhouse*<HAR>H05RRF3G
Number of cores	: 3
Conductor construction	: 32x0,20 mm O.D. 1,30mm
Conductor insulation	: Rubber, O.D. 2,40mm +/-0,05mm
Jacket	: Rubber, O.D.7,20mm +/- 0,30mm
Resistance of conductors	: max. 20 Ω/km
Dielectric strength	: 2kVac, 1min
Insulation resistance	: > 0,010MΩ/km
Color of conductors	: yellow/green, brown, blue
Approvals	: HARMONIZED

3. CONNECTOR : Type C15M+1309

Molded connector according to	: EN/IEC60320/C15
Rated current and voltage	: 10 A, 250 V
Construction	: double insulation
Contacts of the connection	: self-adjusting phosphor bronze CuSn6, crimped
Inner insulation	: housing, PBTP GFR
Max. pin temperature	: 120°C
Outer mold	: PVC compound, hardness Shore A 75-77
Approvals	: CE, ENEC, KTL

ENVIRONMENTAL CONFORMITY

EU-Directive 2012/19/EU (WEEE)
EU-Directive 2011/65/EU
EU-Directive 1907/2006 EG (REACH -compliant)

TESTING

Electrical testing : 100%	High pot test wire to wire: 3kVac for 2 sec
Visual inspection : 100%	Continuity : 25Aac to grounding /20Aac to line and neutral
Polarity test : yes	Skin high pot test : 6kVac line to skin

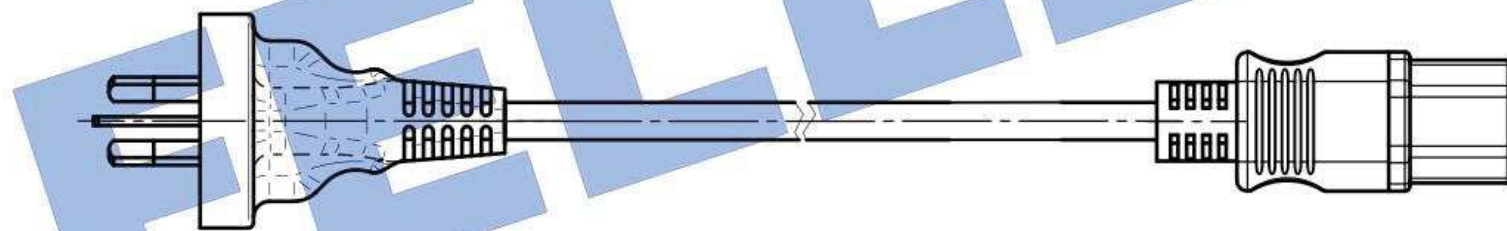
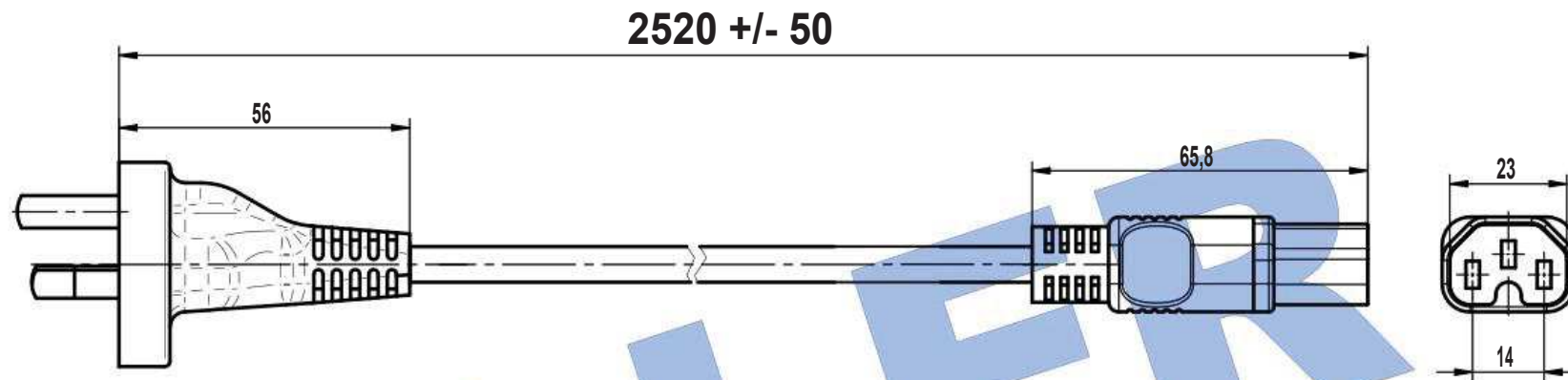
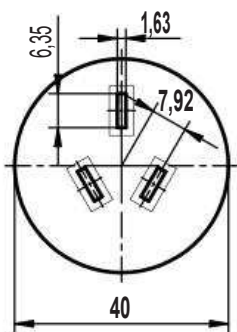

1.
SAA/3+1309

2.
H05RRF3G1,00

3.
C15M+1309

Type : (L105) SAA/3+1309-H05RRF3G100-C15M+1309/2,50m Black



All dimensions in mm

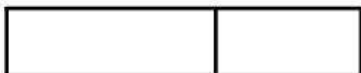

RoHS compliant

COMAREL 

Tel : (33) 1 34 13 72 80
 mail : info@comarel.fr
 site : www.comarel.fr